

SUPPLEMENT TO THE

USER MANUAL

FOR THE ST5 PINION MODEL

ENGLISH

+STROMER-

ST5 PINION COMPONENTS

i If you leave this page unfolded when reading the manual, you can immediately identify which component is being referred to.

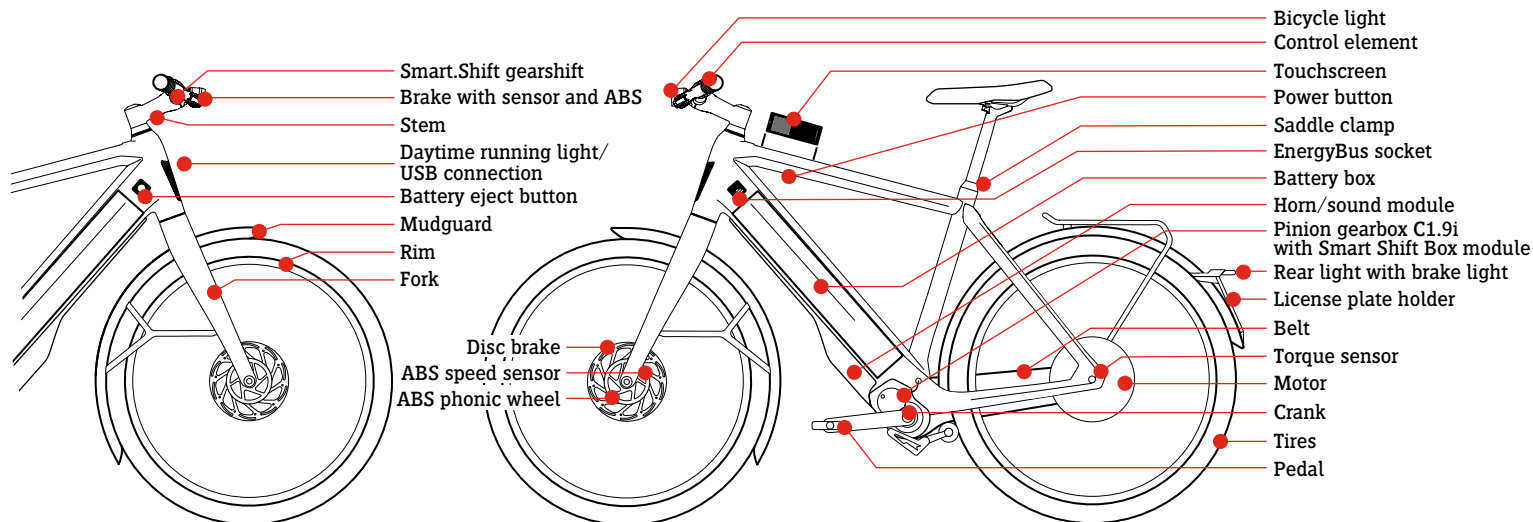

Scope of delivery

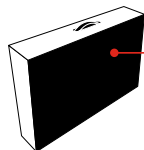

- Contents:**
- Stromer S-Pedelec user manual
 - Battery charger
 - Smartphone holder
 - Pedals
 - Sideview mirror

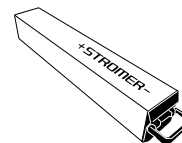
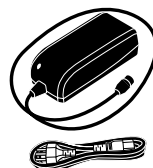

i The S-Pedelec you have purchased may look different from the one depicted in this user manual. This manual describes S-Pedelecs. It is included in the delivery of your S-Pedelec and also applies only to the ST5 Pinion model.

CONTENTS

ST5 Pinion components	2
Introduction	3
Warnings	3
Maintenance and servicing	4
Belt drive	4
Gear system	4
Gear indicator	5
Trigger setting	5
Setting the gear for starting	6
Assistance levels	6
Stromer Sound	7
Stromer Sound setting	7
Cleaning	7
ST5 Pinion tightening torques	7
Legal notice	8

INTRODUCTION

Dear Customer,

In this supplementary sheet, you will find all the relevant information about the different equipment features of your Stromer ST5 Pinion that are not described in the original user manual "User Manual ST1|ST2|ST3|ST5".

This supplementary sheet is only valid when supplied with the original user manual.

Please carefully read both this supplement and the "User Manual ST1|ST2|ST3|ST5". You should only use your ST5 Pinion when you have fully read, understood and implemented the contents of both documents.

Keep both documents safe and follow all instructions provided.

WARNINGS

In this manual, you will find two different warning symbols. When you see these symbols, there is always a risk that the described danger may occur. The area that the respective warning applies to is highlighted in red.

The warnings break down as follows:

 **Warning:** This symbol warns of misuse which could result in damaging the product or the environment.

 **Danger:** This symbol indicates possible dangers to your health and life that could arise if specific actions or appropriate care is not taken.

MAINTENANCE AND SERVICING

Belt drive

Your ST5 Pinion is equipped with a belt drive (Gates Carbon Belt Drive). The automatic tensioning roller saves you from having to check and retension the belt frequently, making it almost maintenance free.

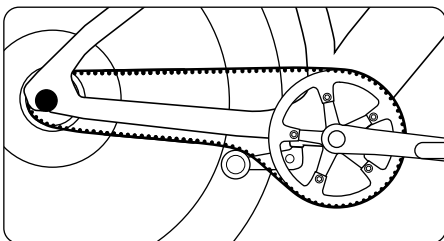

 Please follow the handling instructions below to help make your belt last longer. Improper handling can damage the belt and may mean that it needs replacing!

- Do not bend or twist the belt.
- Do not turn the belt inside out.
- Do not bunch or coil the belt.
- Do not use as a belt tool.
- Do not use tools or sharp instruments when handling the belt.
- Do not push down on the belt pulley.
- Do not oil the belt.

To extend the lifespan of the belt, we recommend cleaning it with water or a hand brush (e.g. after riding through mud or dirt). Residue left on the belt or belt pulleys can result in increased wear and noise generation (e.g., squeaking or creaking).

Use in winter: The belt will not rust but salt crystals may form on the pulley system if salt water is left to dry on it. Even if no dirt is visible, you should wash your bike and belt regularly when using it during winter. Use warm water and a mild detergent or dish soap.

Check your belt drive for damage, deformation or cracks each time you clean it. If you have any doubts, contact your Stromer dealer. If you still notice that the belt system is making noise despite a thorough cleaning, a thin layer of dry silicone spray can be applied to the inside of the belt. This protects it against any further build-up and reduces friction and noise generation.

Gear system

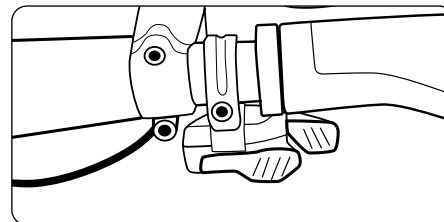



The gears are operated via the Smart.Shift automatic gearshift lever (hereinafter referred to as the “trigger”). The Pinion trigger is an electronic system powered by the S-Pedelec battery.

To change gear, press one of the gearshift levers. To shift up a gear, press the front short lever once. To shift down a gear, press the longer rear lever once. You can change several gears in succession by pressing the lever several times. Shifting while pedaling is possible, but not when the load is too high.

You can find more detailed information in the specific user manuals included in the delivery:

Trigger: Pinion Smart.Shift user manual
Gearbox: Pinion C-Line user manual
or on the website: pinion.eu/smartshift

 You can freely adjust the gearshift lever assignment. Please read the “Trigger setting” chapter for more information.

 Belts and pulleys are optimally matched to each other. Do not change the gear ratio. The warranty and guarantee only apply to original components.

 Gears are safety-relevant components! Read the manufacturer's instructions and familiarize yourself with the operation of your S-Pedelec's gears before riding it for the first time. You can find more information at <https://pinion.eu>. Leave any gear repairs to your Stromer dealer! Any repair work that is not carried out properly may impact the safety of your S-Pedelec! If your gears do not shift cleanly, avoid riding any further if possible. Take your ST5 Pinion to your dealer to be checked.

 You have the option to extend the warranty for the gearbox to three years. You can access Pinion's warranty policy at <https://pinion.eu/en/warranty-extension-info/> or by scanning the QR code.

Scan:



Gear indicator

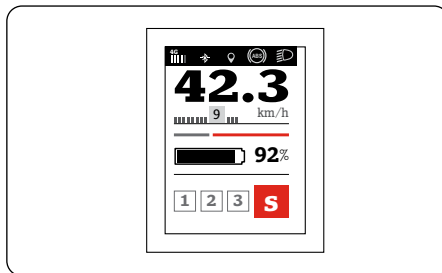

The Pinion gearbox has 9 gears. The driving mode display shows you which gear is currently engaged.

Trigger setting

You can freely assign the gearshift levers. In the shortcut display, select:

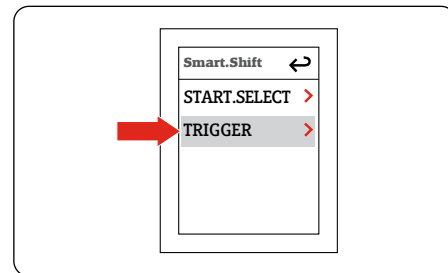
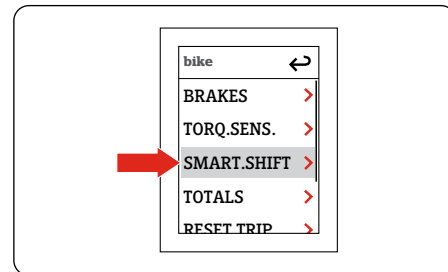
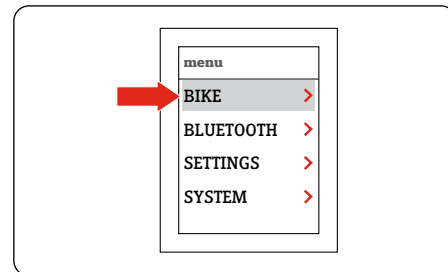
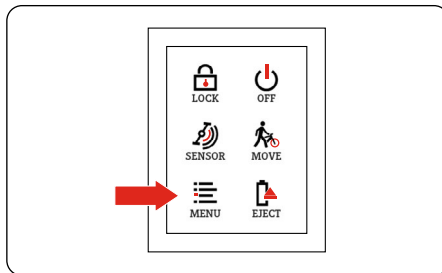

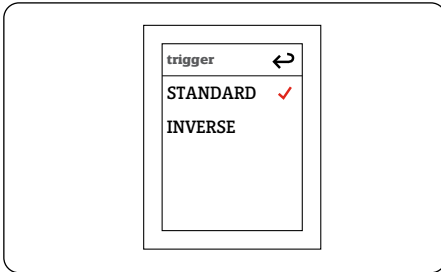

Standard: The front lever shifts up.
The rear lever shifts down.
Inverse: The front lever shifts down.
The rear lever shifts up.

Setting the gear for starting

When starting up after a standstill, the ST5 Pinion automatically shifts to fourth gear. You can set the gear yourself in the settings. In the shortcut display, select:

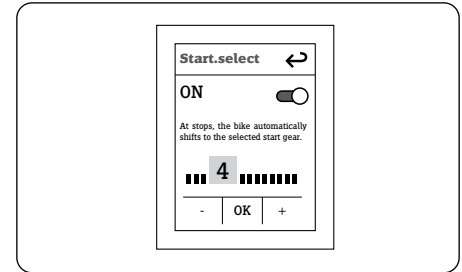
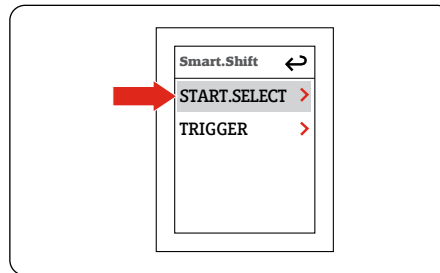
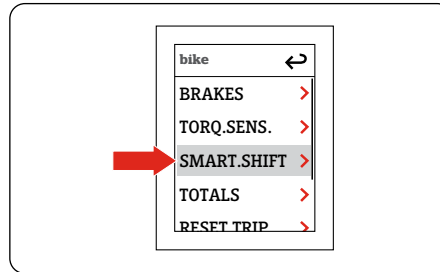
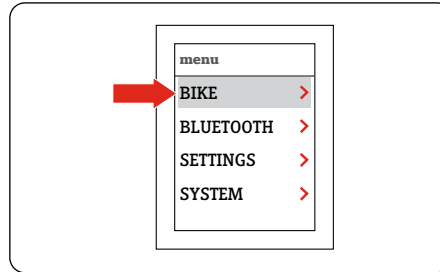
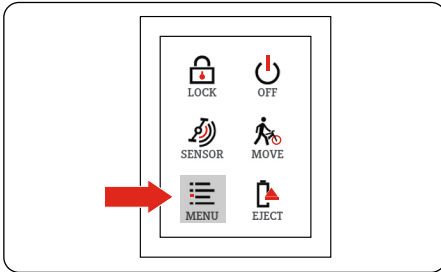

Turn "START.SELECT" on or off: "ON/OFF".
Change gear with "+/-".
Save your settings by pressing "OK".

! The drive system and the battery are subjected to greater stress when you set off in a high gear. It is better to choose a low gear as the starting gear.

Assistance levels

By pressing the "+" and "-" buttons on the control element on the handlebars, you can switch between the following assistance modes:

- Bicycle mode: The motor is switched off.
- Assistance mode 1: Low motor assistance optimized for longer ranges.
- Assistance mode 2: Medium motor assistance – you can fine-tune this assistance mode via the Stromer app.
- Assistance mode 3: High motor assistance for maximum speed.
- Assistance mode S: Very high motor assistance for short-term maximum assistance.

Stromer Sound

Your Stromer ST5 Pinion is equipped with an integrated speaker (4 Ohm).

An acoustic signal sounds when you switch the S-Pedelec on and off and when your battery reaches a charge level of 100%.

Stromer Sound setting

You can switch Stromer Sound on or off in the menu of the Stromer bike display and also adjust the volume of the acoustic signals.

Select Settings / Sound in the menu and click + or - to adjust the volume or to set it to 0, or switch it off.

Save the setting with "OK".

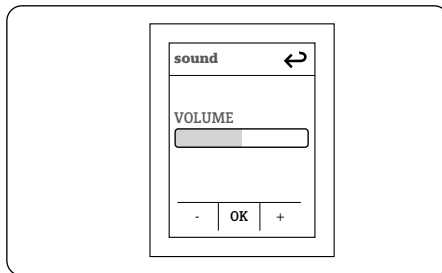
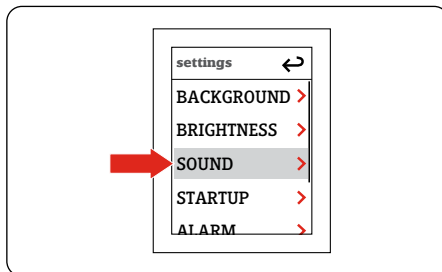
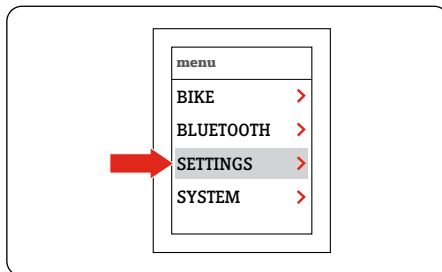
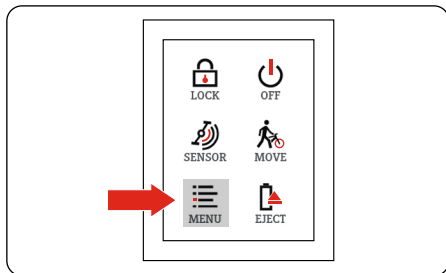

Cleaning

Only clean your S-Pedelec when the electronic components, e.g. battery box or charging socket, are fully installed, locked and inserted.

ST5 Pinion tightening torques

For assembly and maintenance work, different tightening torques must be used in some cases for the ST5 Pinion. Always have work that does not concern the Smart.Shift carried out by a specialist workshop.



Have all assembly and repair work on the Smart.Shift gearbox and Smart.Shift box carried out by an authorized specialist workshop.

LEGAL NOTICE

myStromer AG
Freiburgstrasse 798
CH-3173 Oberwangen, Switzerland

Europe:

info@stromerbike.com

USA:

serviceusa@stromerbike.com

Company responsible for distributing and marketing the user manual: inMotion mar.com
Rosensteinstr. 22, D-70191 Stuttgart, Germany
info@inmotionmar.com,
www.inmotionmar.com

Text: Veidt Anleitungen
Friedrich-Ebert-Straße 32, D-65239 Hochheim,
Germany
anleitungen@thomas-veidt.de

Illustrations: myStromer AG

© This document, or parts thereof, cannot be reproduced, reprinted, translated or used for commercial purposes, either in printed or electronic form, without prior written consent.

ST5 Pinion EN Version 1.0
September 2023

Version 1.0
Artikel Nr. 404916
User Manual ST5 Pinion supp. sheet

myStromer AG

Freiburgstrasse 798 | CH-3173 Oberwangen | Switzerland
stromerbike.com | info@stromerbike.com

+STROMER-